

21st June\_0900

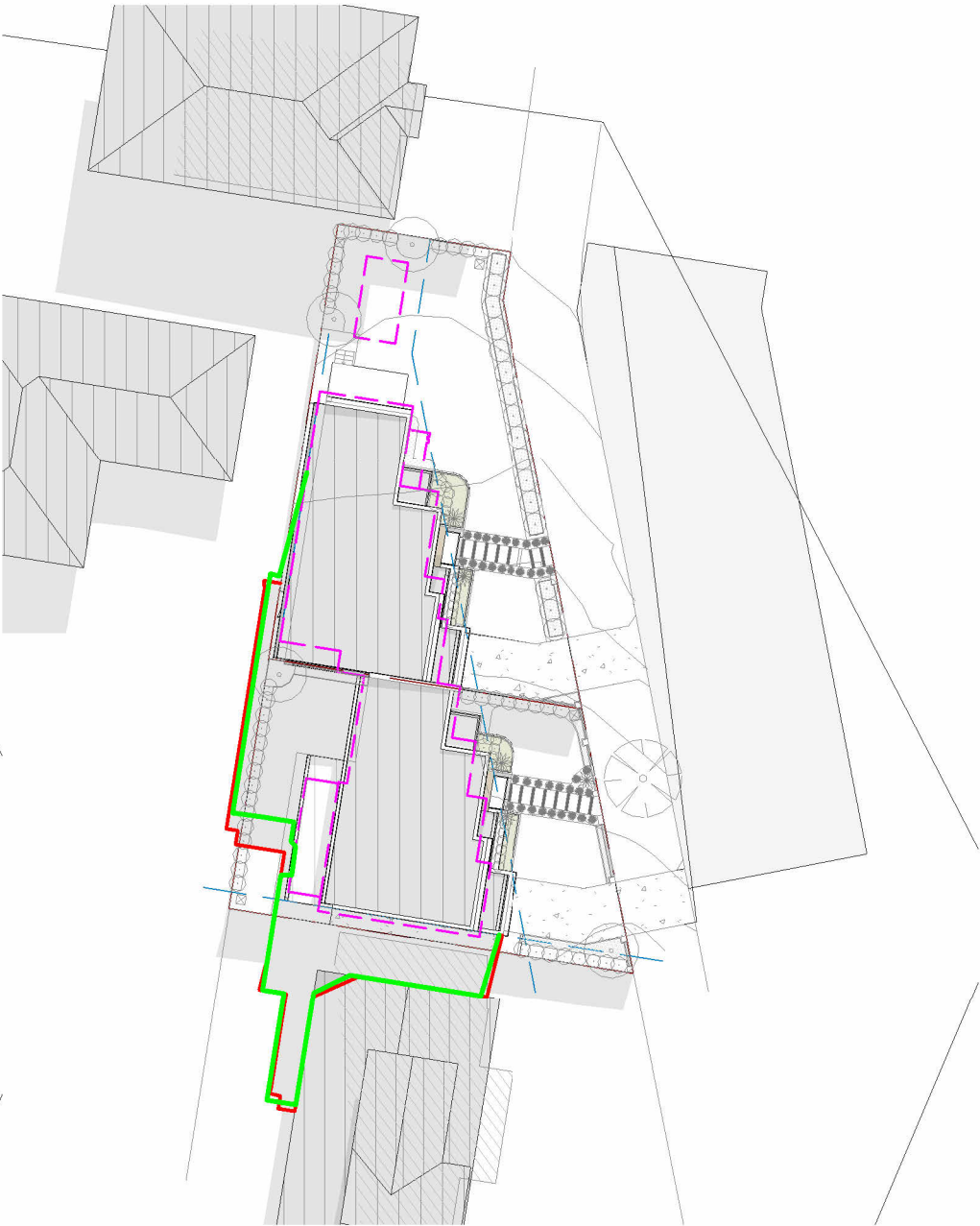

21st June\_1000



21st June\_1100

- CASTING SHADOW LINE \_S4.55
- CASTING SHADOW LINE \_APPROVED DA
- BUILDING ENVELOPE \_APPROVED DA

Client

Issue	Description	Date
1	S4.55	090528

Builder and/or subcontractors shall verify all project dimensions before commencing on-site work or off-site fabrication. Figured dimensions shall take precedence over scaled dimensions. This drawing is copyright and cannot be reproduced in whole or in part or by any medium without the written permission of EYA Pty Ltd.

S4.55

Project Name  
50 Adelaide Road Padstow

Project Address  
50 Adelaide Road Padstow

Drawing Title:  
Shadow Diagrams

Date:  
090528  
Drawing Number:  
DA801

Sheet Size:  
A3  
Issue:  
1

Scale:  
0 2000





EYA BUILDING DESIGN  
ABN: 46 831 457 510  
Nomanited Architect: Xiaocheng Liu NSW ARB 12513  
Contact Detail:Ericy@eyarchitecture.com.au

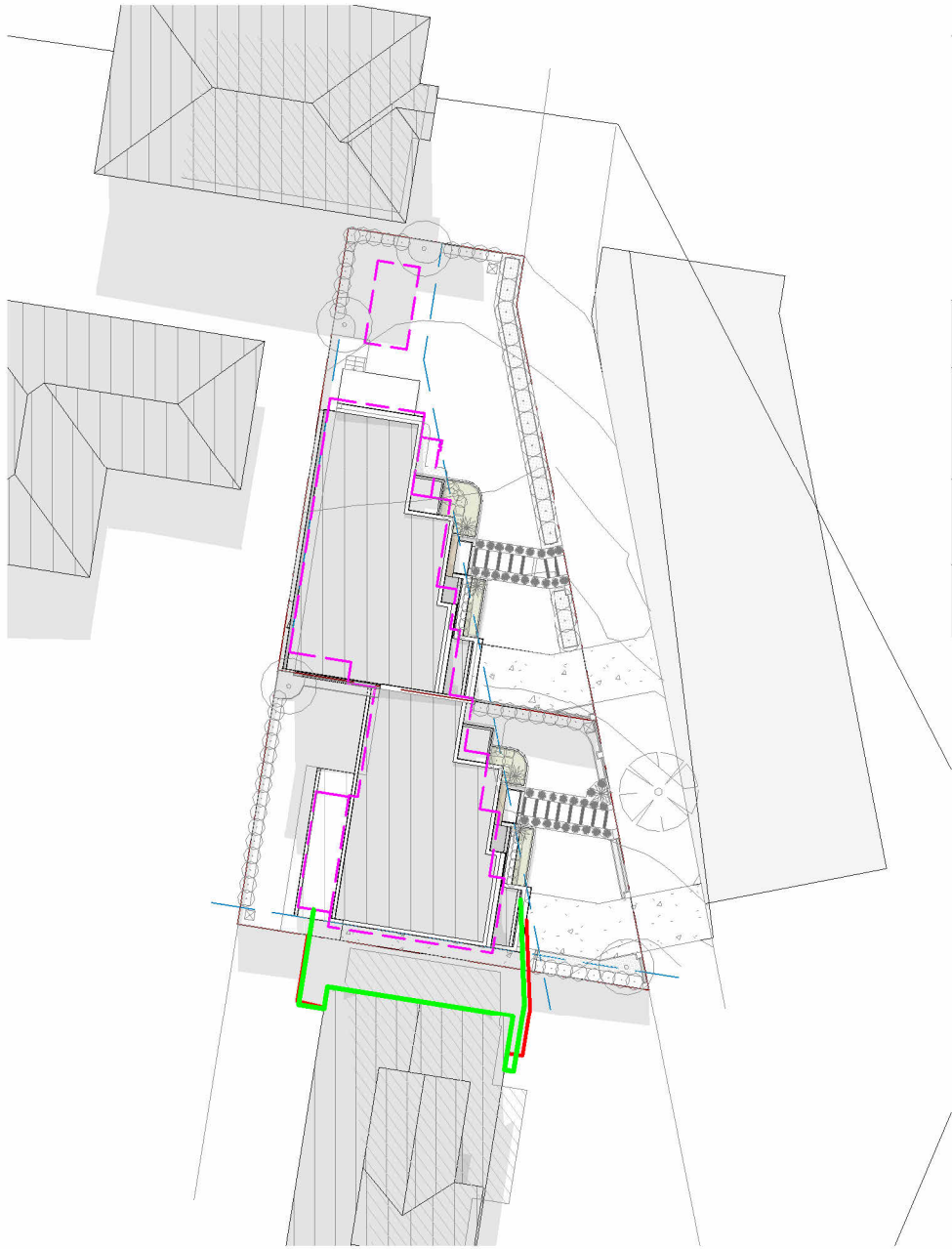

1 21st June\_1200  
DA200 1 : 400

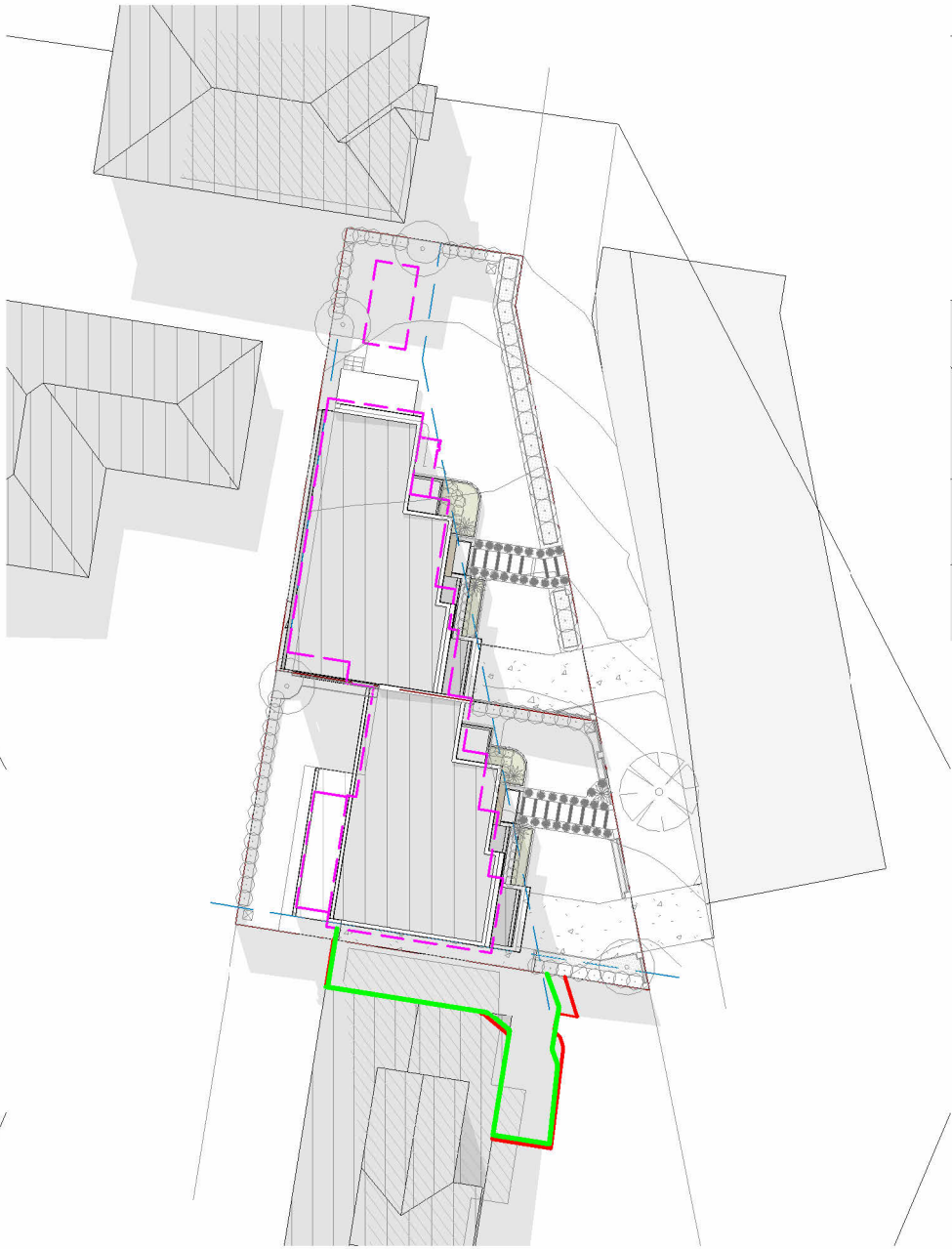

2 21st June\_1300  
DA200 1 : 400

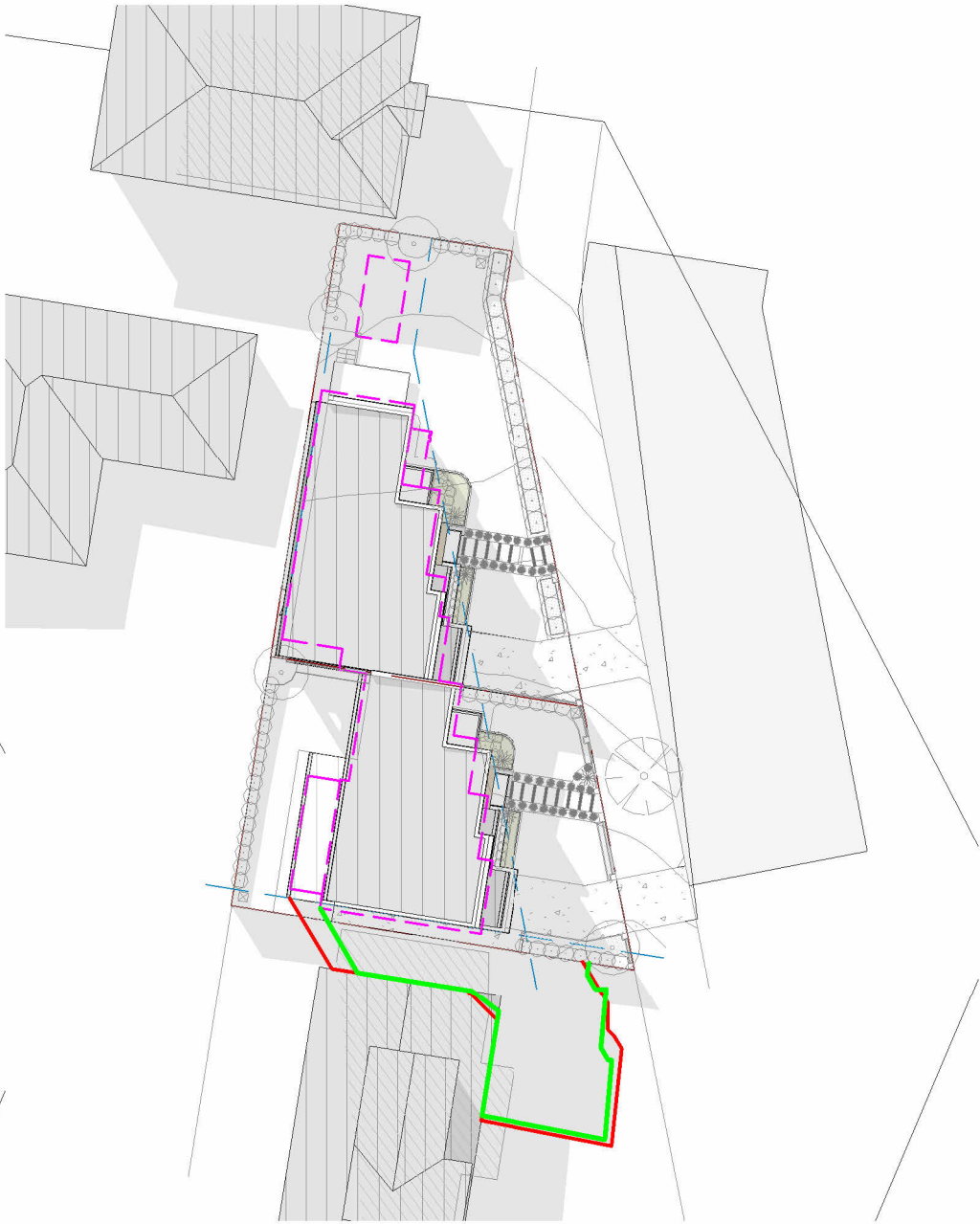

3 21st June\_1400  
DA200 1 : 400

- CASTING SHADOW LINE \_S4.55
- CASTING SHADOW LINE \_APPROVED DA
- BUILDING ENVELOPE \_APPROVED DA

Client

Issue	Description	Date
1	S4.55	090528

Builder and/or subcontractors shall verify all project dimensions before commencing on-site work or off-site fabrication. Figured dimensions shall take precedence over scaled dimensions. This drawing is copyright and cannot be reproduced in whole or in part or by any medium without the written permission of EYA Pty Ltd.

S4.55

Project Name  
50 Adelaide Road Padstow

Project Address  
50 Adelaide Road Padstow

Drawing Title:  
Shadow Diagrams 2

Date:  
090528  
Drawing Number:  
DA802

Sheet Size:  
A3  
Issue:  
1

Scale:  
0 2000



EYA BUILDING DESIGN  
ABN: 46 831 457 510  
Nomanited Architect: Xiaocheng Liu NSW ARB 12513  
Contact Detail:Ericy@eyarchitecture.com.au



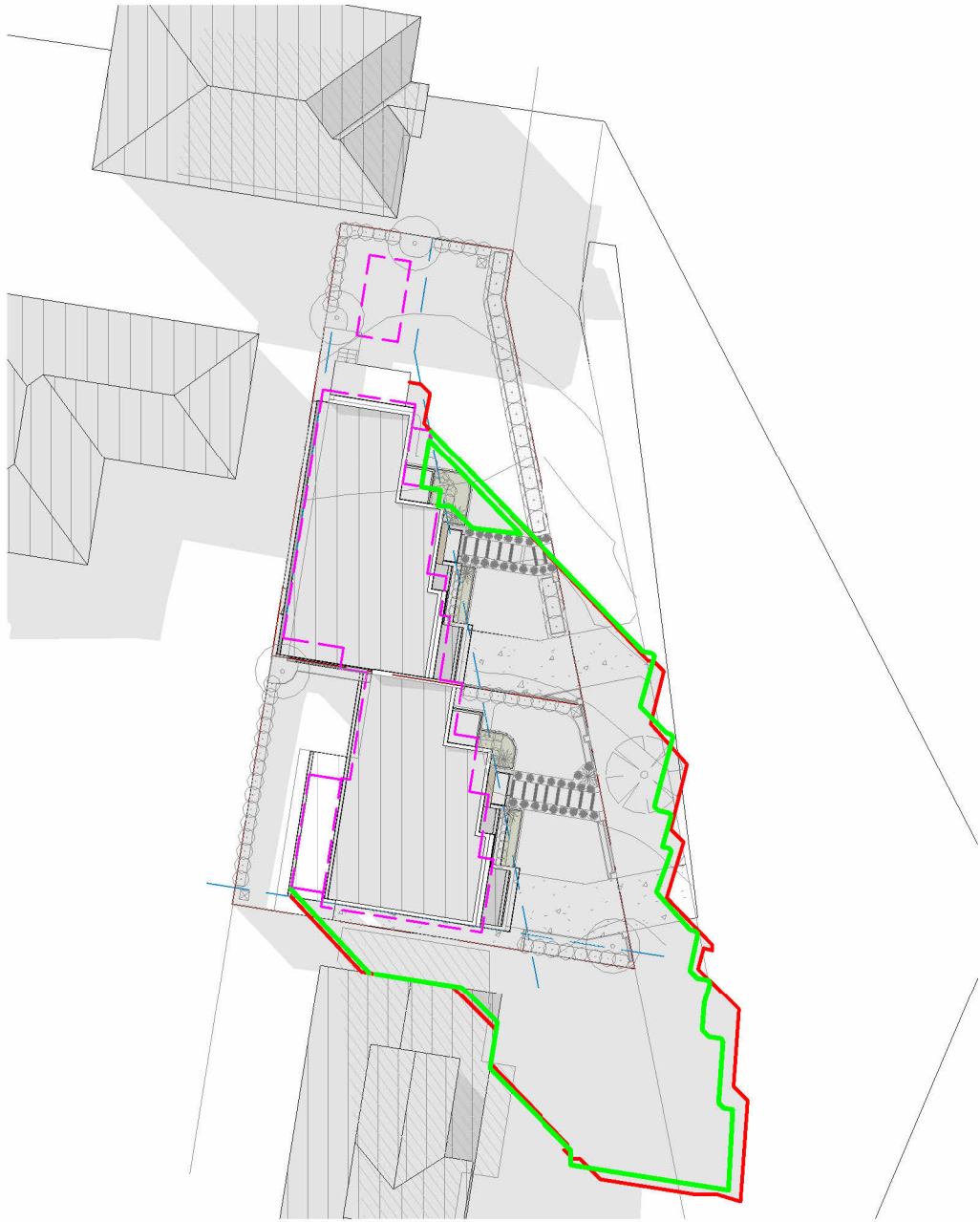

1 21st June\_1500  
DA200 1 : 400

The proposed shadow impact resulting from the Section 4.55 envelope remains consistent with the previously approved DA envelope. The modification focuses on refining the internal room layout and addressing constructability issues, with the aim of improving buildability and achieving a more cost-effective outcome.

- CASTING SHADOW LINE \_S4.55
- CASTING SHADOW LINE \_APPROVED DA
- BUILDING ENVELOPE \_APPROVED DA

Client

Issue	Description	Date
1	S4.55	090528

Builder and/or subcontractors shall verify all project dimensions before commencing on-site work or off-site fabrication. Figured dimensions shall take precedence over scaled dimensions. This drawing is copyright and cannot be reproduced in whole or in part or by any medium without the written permission of EYA Pty Ltd.

S4.55

Project Name  
50 Adelaide Road Padstow

Project Address  
50 Adelaide Road Padstow

Drawing Title:  
Shadow Diagrams3

Date:  
090528  
Drawing Number:  
DA803

Sheet Size:  
A3  
Issue:  
1

Scale:  
0 2000



EYA BUILDING DESIGN  
ABN: 46 831 457 510  
Nomanited Architect: Xiaocheng Liu NSW ARB 12513  
Contact Detail:Ericy@eyarchitecture.com.au